

# HUNTERS<sup>®</sup>

HERE TO GET *you* THERE



## Mitcham Lane

London, SW16 6NA

£1,600 Per Calendar Month



A beautifully presented one double bedroom apartment set on the top floor of a well-maintained period conversion offering 580 sq ft of living space.

This stylish home offers bright, modern interiors throughout, featuring a welcoming entrance with a dedicated workspace area, a spacious open-plan living and dining room, a generous double bedroom with fitted wardrobes, a contemporary bathroom with quality fittings and from off street parking.

Ideally situated on Mitcham Lane, the property is moments from the independent cafés, restaurants, and shops of Moyser Road, while Streatham Common Station provides fast links into Central London. Excellent local bus routes also offer convenient connections to Streatham, Balham, and Tooting.

Perfect for professionals or couples seeking a well-connected home with character and style.



Area Map

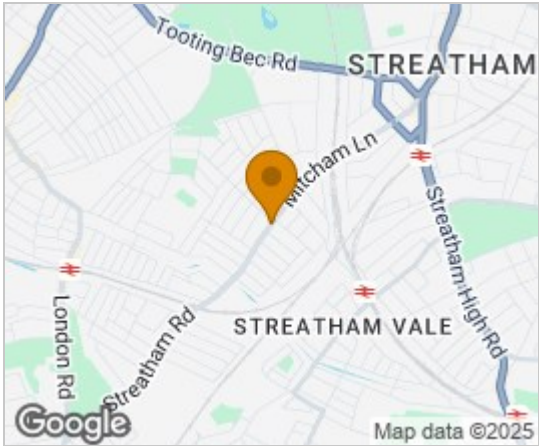

Floor Plans

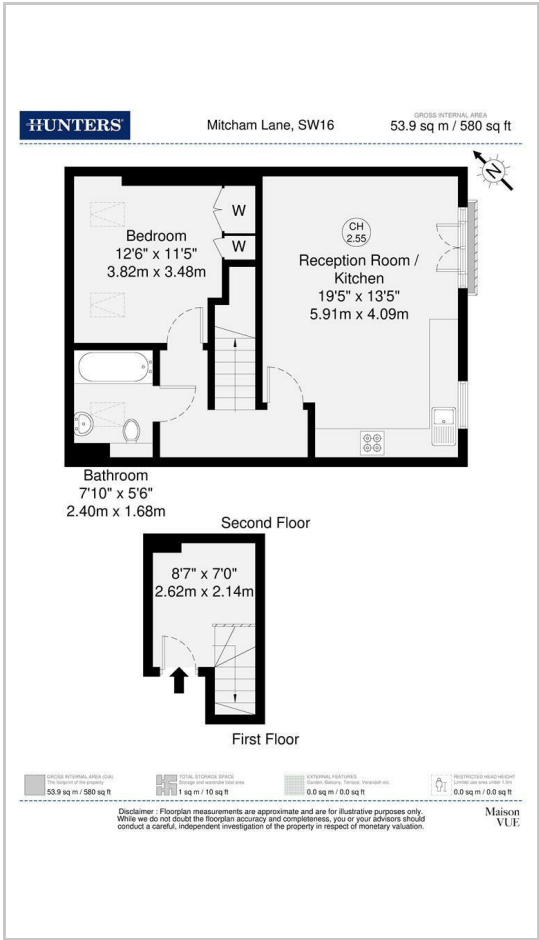

Energy Efficiency Graph

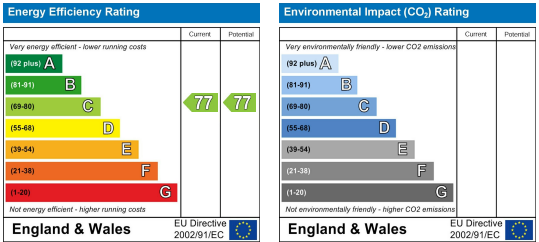

These particulars are intended to give a fair and reliable description of the property but no responsibility for any inaccuracy or error can be accepted and do not constitute an offer or contract. We have not tested any services or appliances (including central heating if fitted) referred to in these particulars and the purchasers are advised to satisfy themselves as to the working order and condition. If a property is unoccupied at any time there may be reconnection charges for any switched off/disconnected or drained services or appliances - All measurements are approximate.

**THINKING OF SELLING?** If you are thinking of selling your home or just curious to discover the value of your property, Hunters would be pleased to provide free, no obligation sales and marketing advice. Even if your home is outside the area covered by our local offices we can arrange a Market Appraisal through our national network of Hunters estate agents.